



Chloride Test Kit

CD-51 (208601)

DOC326.97.00109

Test preparation

CAUTION: Review the Safety Data Sheets (MSDS/SDS) for the chemicals that are used. Use the recommended personal protective equipment.

- Hold the dropper vertically above the sample. Do not let the dropper touch the bottle during the titration.
- Rinse the tubes and bottles with sample before the test. Rinse the tubes and bottles with deionized water after the test.
- To record the test result as mg/L sodium chloride (NaCl), multiply the chloride result by 1.65.

Test procedure—Chloride (0–10,000 mg/L Cl⁻)

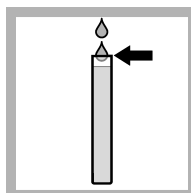

1. Fill the measuring tube with sample.



2. Pour the sample into the mixing bottle.

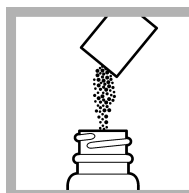

3. Add one Chloride 2 Indicator Powder Pillow.



4. Turn the bottle left and right to mix.

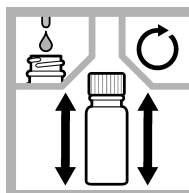

5. Add the Silver Nitrate Titrant by drops. Tighten the cap on the bottle and shake vigorously after each drop. Count the drops until the color changes from yellow to red-brown.

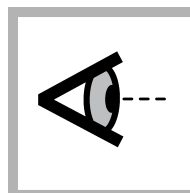

6. If the precipitate is orange but the solution color is yellow, start the test again with a new sample and shake the sample more.

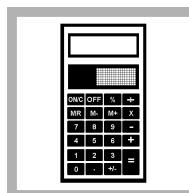

7. Multiply the total number of drops by 500 to get the result in mg/L.

Test procedure—Chloride (0–100,000 mg/L Cl⁻)

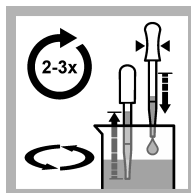

1. Rinse the plastic dropper two or three times with the sample water.

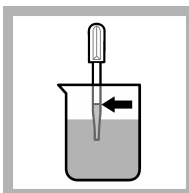

2. Fill the dropper to the mark with the sample.

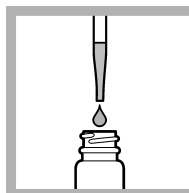

3. Add the sample to the mixing bottle.

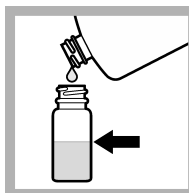

4. Add deionized water to the mixing bottle until the mixing bottle is approximately half full.

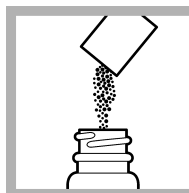

5. Add one Chloride 2 Indicator Powder Pillow.

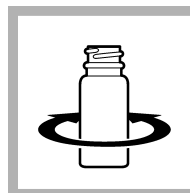

6. Turn the bottle left and right to mix.

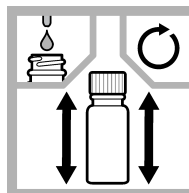

7. Add the Silver Nitrate Titrant by drops. Tighten the cap on the bottle and shake vigorously after each drop. Count the drops until the color changes from yellow to red-brown.

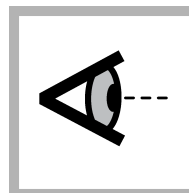

8. If the precipitate is orange but the solution color is yellow, start the test again with a new sample and shake the sample more.

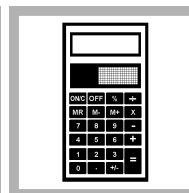

9. Multiply the total number of drops by 5000 to get the result in mg/L.

Replacement items

NOTE: Product and Article numbers may vary for some selling regions. Contact the appropriate distributor or refer to the company website for contact information.

Description	Unit	Item no.
Chloride 2 Indicator Powder Pillows	100/pkg	104399
Chloride Titrant, silver nitrate, 1.88 N	100 mL MDB	2349432
Water, deionized	100 mL	27242
Bottle, square, glass, 29 mL	6/pkg	43906
Cap, bottle	6/pkg	2166706
Dropper, plastic	each	217500
Measuring tube, plastic, 5.83 mL	each	43800

